

Product Name	Tsubaki Seamless Light Type H Duo (Tunable White)	Scale	1:2 (A4)
--------------	--	-------	-----------------

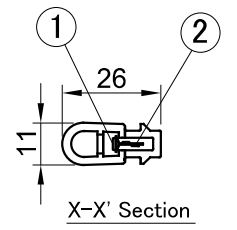

Cable color means below.
 Red cable : V+
 Yellow cable : V- for 2200K
 White cable : V- for 5500K

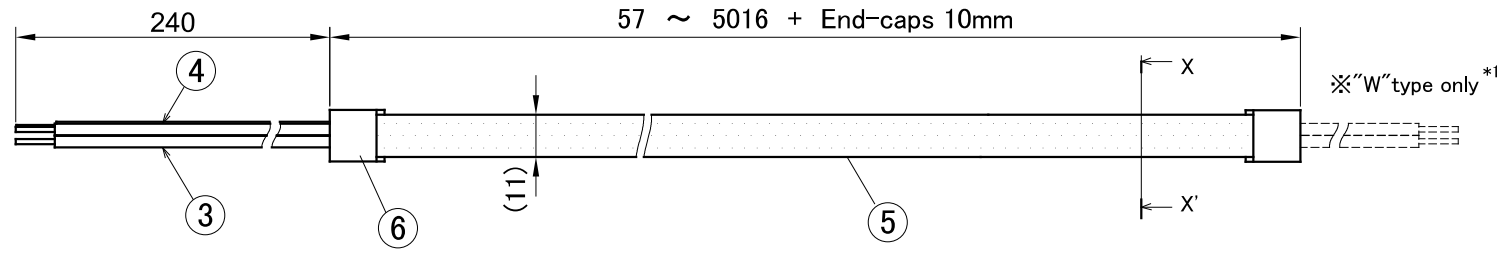
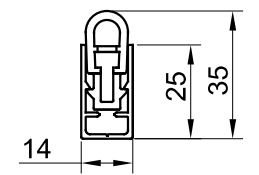
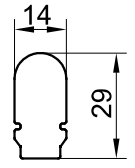
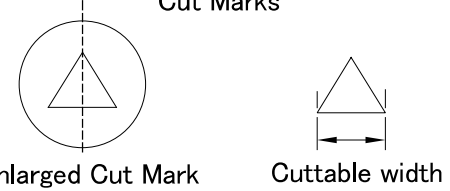
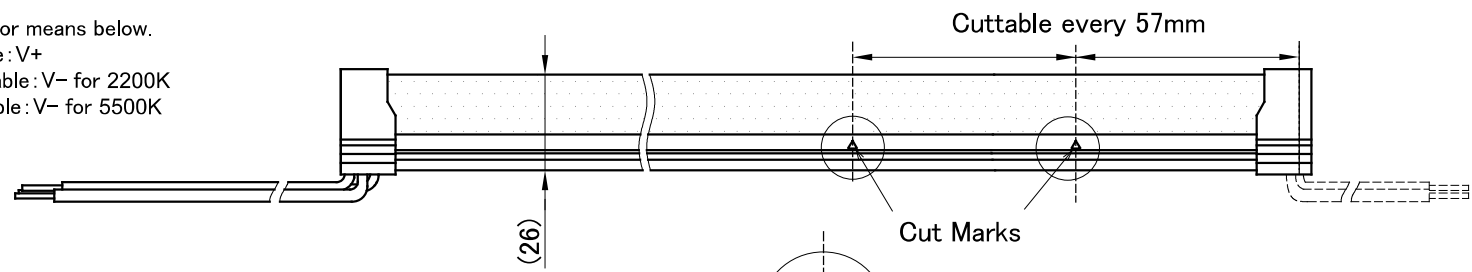

Cross-sectional sizes when installed with FAC20-01GD / FAS00-01GD

Length(m)	~1	~3	~5
Tolerance(mm)	+10 ~ -11	+10 ~ -16	+10 ~ -20

Note:
 When connecting products and power supplies in parallel in multiple systems, make sure that the types and lengths of the wires in each system are the same to prevent differences in brightness and color between the products.

Third-angle projection method (Unit: mm)

Product Specifications		8			
Product No.	GLD-TU	7			
Length	57mm ~ 5016mm + End-caps 10mm	6	End cap	Silicone rubber	Translucent
Weight	260g/m	5	Case	Silicone rubber	Milky White
Input Voltage	DC24V	4	Lead wire (V-)	Silicone rubber coating	Yellow, White, AWG20 (0.5 sq)
Power Consumption	Max. 17W/m (2200K only: 9W/m, 5500K only: 8W/m)	3	Lead wire (V+)	Silicone rubber coating	Red, AWG20 (0.5 sq)
Color Temperature	2200K ~ 5500K	2	LED	SMD LED	
Luminous Flux	Max. 1120lm/m (2200K only: 540lm/m, 5500K only: 620lm/m)	1	FPC	Polyimide	
Color Rendering Index (Ra)	84 ~ 89				
Beam Angle	205°				
Operating Temperature	-10 ~ 55°C				
Environment	Indoor / Outdoor. IP67 rated.				
Bending Radius	R60 mm horizontal				
Max unit Connectable	5m(5016mm + End-caps)				
Note	*1 "(Standard)" type : Lead wires at one end. "W" type : Lead wires at both ends.				

Parts Name	Material	Note
Parts List		
1 Aluminum channel for straight line (L=1000 mm) : FAS00-01GD		
2 Aluminum channel for curvy line (L=1000 mm) : FAC20-01GD		
3 End cap : EC109-02		
4		
5		



Drawn	Reviser	Approved
Shiokawa	Kawasaki	Yamaguchi
2024.6.25	2024.11.1	2024.11.1

Please note that the contents described above may be changed without any advance notice.